



### 302/791-795 Botany Road Rosebery NSW

1 1

Immerse yourself in the heart of Sydney's inner-city buzz at Rosebery! This up-and-coming neighborhood offers the perfect blend of convenience and excitement. Live just 5km from the CBD while enjoying a vibrant local scene with trendy cafes and restaurants popping up everywhere. City buses stop right outside your door, and Green Square Station is nearby for easy access to the rest of the city.

Additional, Loom's location connects you to the friendly communities of Zetland and Green Squares East Village. It's not just an apartment; it's your launchpad to a dynamic and well-connected lifestyle.

#### Main Features:

- \*\* Spacious bedroom with built-in robe for ample storage.
- \*\* Expansive living/dining area, opening onto a private balcony

**Price** : Contact Agent | Make An Offer  
**Building Size** : 61 sqm  
**View** : <https://www.hspartners.com.au/7964660>



**Andy Haisheng Shi**  
02 9643 5888



**Angela Qiuling Zhang**  
02 9643 5888

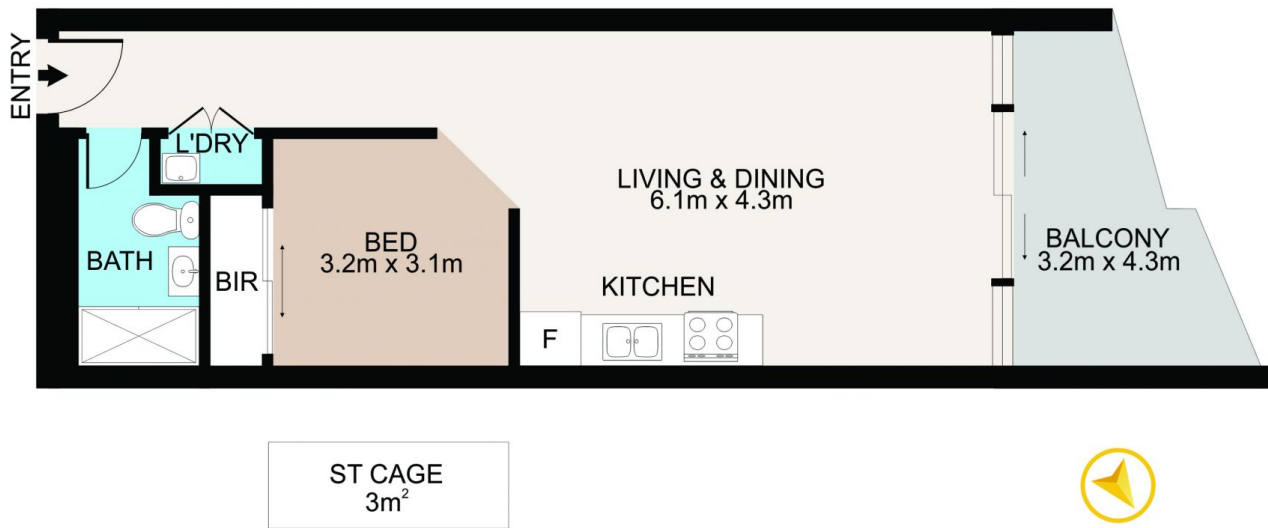

**302/791 Botany Rd, Rosebery**



Scale in metres. Indicative only. Dimensions are approximate. All information contained herein is gathered from sources we believe to be reliable. However we cannot guarantee its accuracy and interested persons should rely on their own enquiries