



20a Belgium Street Auburn NSW

5 🛏 5 🚿 2 🚗

A newly completed residence of rare architectural confidence, 20A Belgium Street delivers an exceptional standard of craftsmanship rarely seen in Auburn. Positioned in one of the area's most desirable pockets and just moments from the Auburn Botanic Gardens, this newly completed torrens-title residence showcases a bold sculptural design paired with a refined material palette and true resort-style entertaining.

From first approach, the home commands presence with its textured render façade, natural marble external staircase, oversized pivot entry door and commercial-grade glazing. Built with double brick construction on the ground floor and a suspended concrete first-floor slab, the residence is engineered for permanence, further enhanced by a solid

Type : Semi Detached
Price : Contact Agent
Land Size : 382.8 sqm
View : <https://www.hspartners.com.au/8680672>

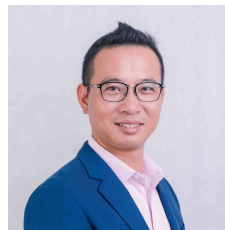

Andy Haisheng Shi
02 9643 5888

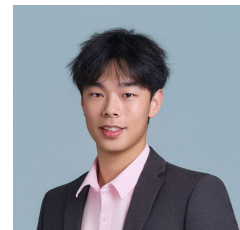

Augustine Shi
02 9643 5888

[For full version visit the website](https://www.hspartners.com.au)

<https://www.hspartners.com.au>

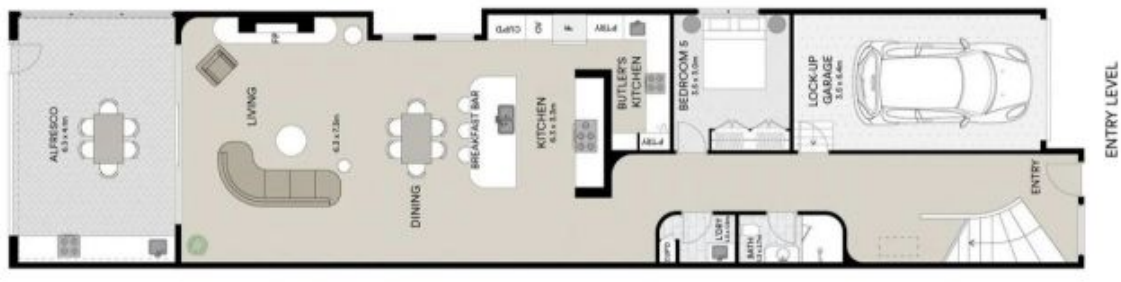

20a Belgium Street, Auburn

Disclaimer:
 The information provided on this floor plan is shown for presentation purposes only and are not part of any legal document or title. They are subject to errors, omissions, inaccuracies and should not be used as a sole and accurate reference. Interested parties should make their own inquiries using independent sources.

